

GEOPROBE® MODEL MB470 MECHANICAL BLADDER PUMP

STANDARD OPERATING PROCEDURE

Technical Bulletin No. MK3013

PREPARED: November, 2003

REVISED: July, 2006

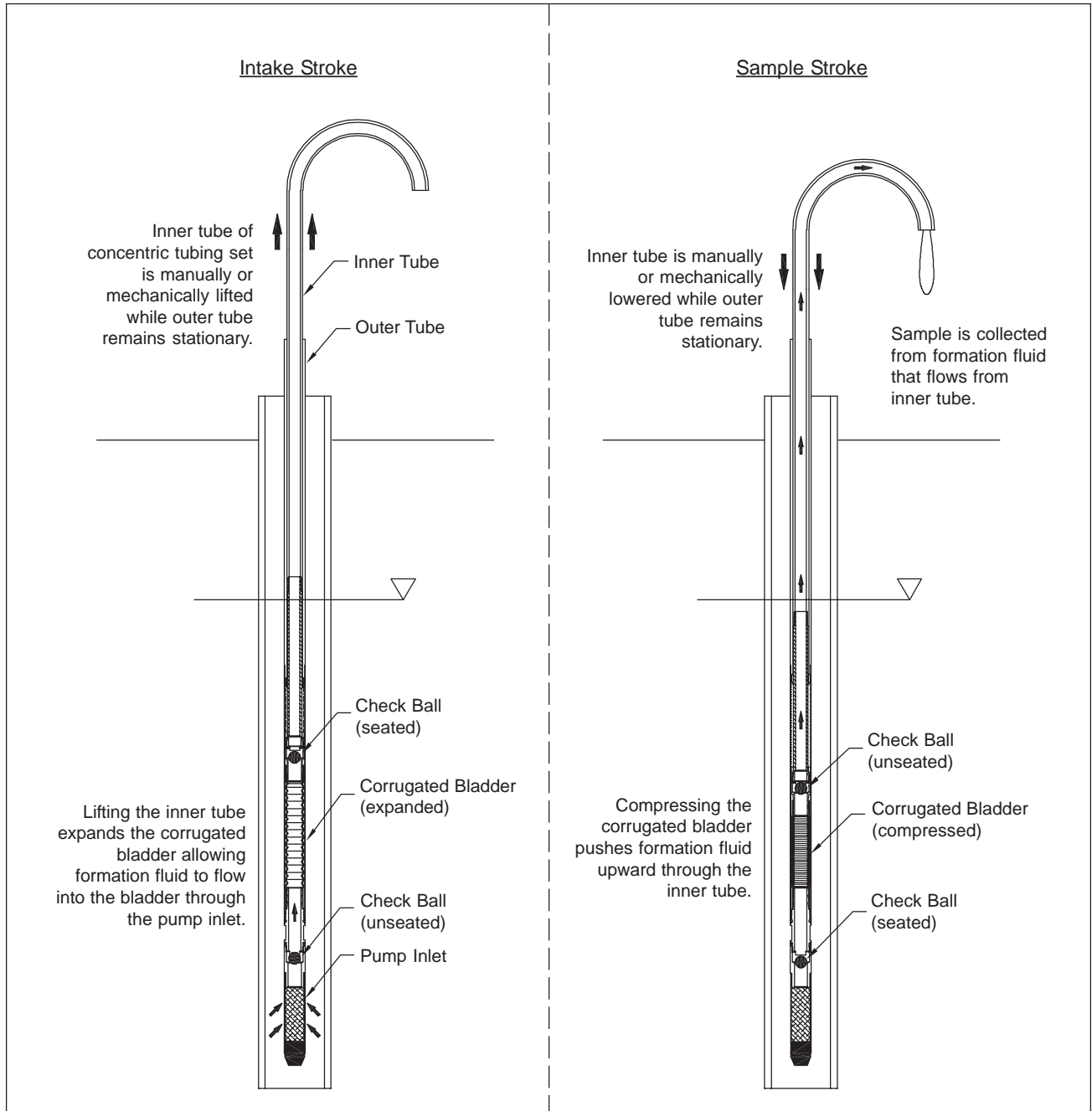

INTAKE AND SAMPLE STROKES OF THE MB470 MECHANICAL BLADDER PUMP



**Geoprobe® and Geoprobe Systems®, Macro-Core® and Direct Image®
are Registered Trademarks of Kejr, Inc., Salina, Kansas**

**The Mechanical Bladder Pump is manufactured under
U.S. Patent No. 6,877,965 issued April 12, 2005.**

©2003 Kejr, Inc.

ALL RIGHTS RESERVED.

No part of this publication may be reproduced or transmitted in any form or by any means, electronic or mechanical, including photocopy, recording, or any information storage and retrieval system, without written permission from Kejr, Inc.

1.0 OBJECTIVE

The objective of this document is to provide guidance on how to collect a representative sample of the subsurface formation fluid utilizing the Geoprobe® Model MB470 Mechanical Bladder Pump.

2.0 BACKGROUND

2.1 Definitions

Geoprobe®*: A brand name of high quality, hydraulically-powered machines that utilize both static force and percussion to advance sampling and logging tools into the subsurface. The Geoprobe® brand name refers to both machines and tools manufactured by Geoprobe Systems®, Salina, Kansas. Geoprobe® tools are used to perform soil core and soil gas sampling, groundwater sampling and testing, soil conductivity and contaminant logging, grouting, and materials injection.

**Geoprobe® and Geoprobe Systems® are registered trademarks of Kejr, Inc., Salina, Kansas.*

MB470 Mechanical Bladder Pump (MBP):** A device for obtaining high-quality, low-turbidity samples from groundwater monitoring wells and direct push installed groundwater samplers as small as .5 inches (13 mm) inside diameter (ID). The MBP may be used to meet requirements of the low-flow sampling protocol (Puls and Barcelona 1996, ASTM 2003). Through participation in a U.S. EPA Environmental Technology Verification study, it was confirmed that the MB470 can provide representative samples (EPA 2003).

***The Mechanical Bladder Pump is manufactured under U.S. Patent No. 6,877,965 issued April 12, 2005.*

Within the MB470 pump body, a corrugated Teflon® fluorinated ethylene propylene (FEP) bladder is mechanically compressed and expanded to push groundwater to the surface through a concentric tubing set. Check valves above and below the bladder control flow direction. The outer tube of the concentric tubing set holds the pump body in place while the inner tube is used to actuate the bladder and transmit water to the surface. The pump body and internal components are made of stainless steel with an outside diameter (OD) of .47 inches (12 mm) and an overall length of 26.75 inches (679 mm) with an inlet screen assembly installed.

2.2 MBP System Components

The three basic components of the Model MB470 Mechanical Bladder Pump system are the pump, concentric tubing set, and actuator.

Pump

All pump components (Fig. 2.1) are made of stainless steel material with the exception of the three fluorosilicone O-rings and the Teflon® bladder.

Beginning at the downhole end of the pump, either a Bullet Nose Intake (P/N 20675) or Inlet Screen Assembly (P/N 20725) may be used as determined by project requirements. The screen assembly includes a 60 mesh wire screen with an actual screen length of 6 inches (152 mm). The bullet nose intake is open at the leading end and provides no filtering effect.

Above the intake/inlet, the pump body contains the corrugated bladder and check balls that physically move groundwater to the surface for purging and sampling. As the top of the bladder is extended, the expanding action of the bladder draws groundwater into the bladder through the intake/inlet. Compressing the bladder then pushes the groundwater up through the connected inner tube of the concentric tubing set. Check balls at the Upper and Lower Bladder Adapters (P/N 20679 and 20677) control groundwater flow through the bladder.

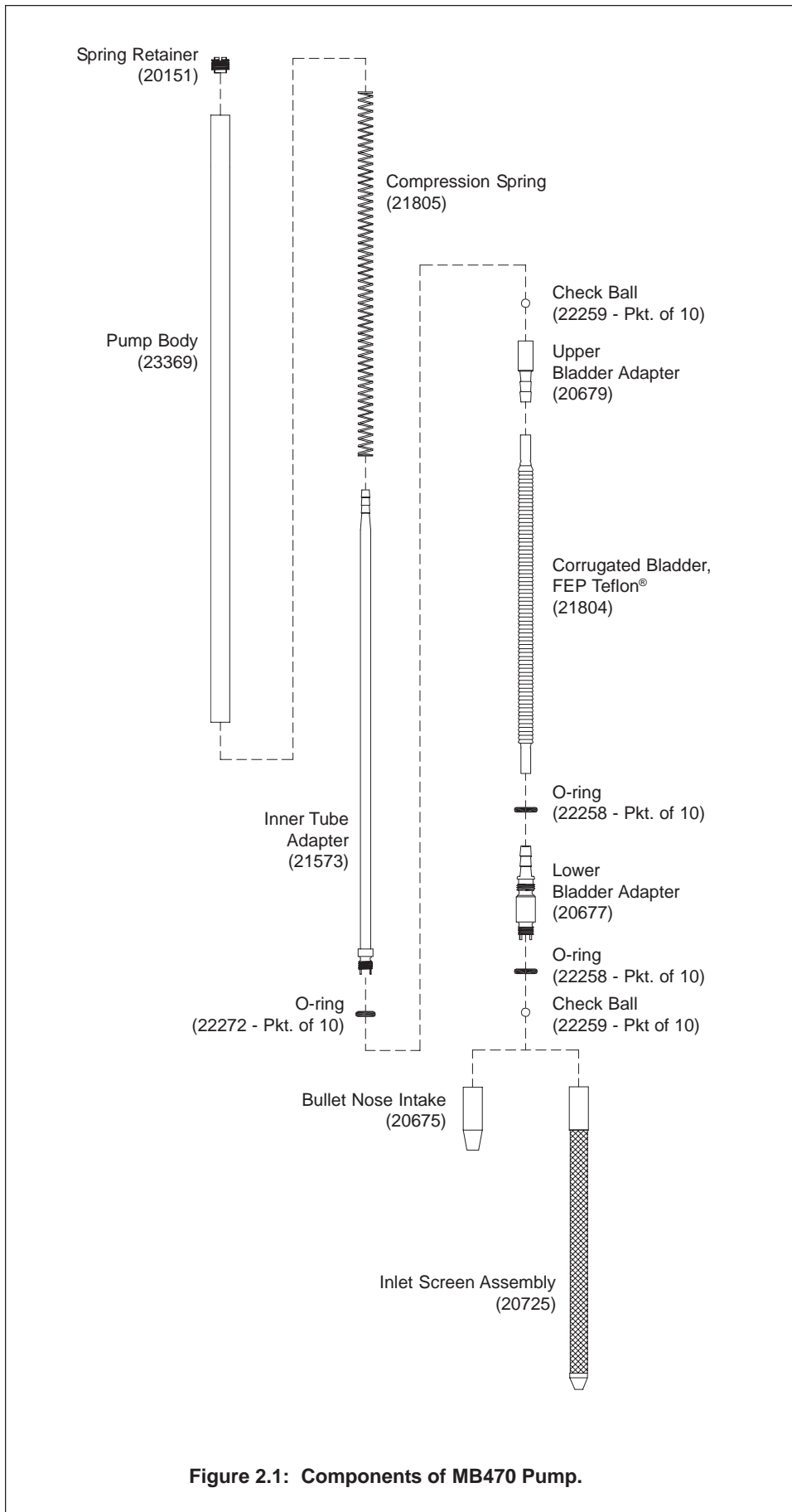

The lower end of the corrugated bladder is secured to the pump body by the Lower Bladder Adapter (P/N 20677). The top of the bladder is attached to the inner tube of the concentric tubing set by the Upper Bladder Adapter (P/N 20679) and Inner Tube Adapter (P/N 21573). During operation of the pump, the inner tube is raised and lowered to expand and contract the bladder to move formation fluid to ground surface.

Concentric Tubing Set

A concentric tubing set for the MB470 Mechanical Bladder Pump commonly consists of .19-inch (5 mm) ID / .25-inch (6 mm) OD Teflon® fluorinated ethylene propylene (FEP) tubing surrounded by .31-inch (8 mm) ID / .44-inch (11 mm) OD high-density polyethylene (HDPE) tubing. Where allowed by project requirements, other materials (e.g. low-density polyethylene (LDPE) tubing) may be utilized in place of the Teflon® inner tubing.

Available lengths for the concentric tubing set are 50 and 100 feet (15.2 and 30.5 m). Custom lengths may be assembled from 500-foot rolls of appropriate tubing sizes and materials, some of which are listed on Page 6.

Refer to the magnified view in Figure 2.2. The inner tube of the concentric tubing set is attached to the Inner Tube Adapter (P/N 21573) during assembly of the MB470 pump. The outer tube is then threaded inside the top end of the pump body. Once lowered down the sampler or monitoring well, the outer tube is held stationary either manually or by attachment to a mechanical actuator. The inner tube is raised and lowered by hand or through use of the mechanical actuator to expand and compress the pump bladder. Formation fluid is thus drawn into the pump bladder and then pushed to ground surface.

Actuator

Actuators provide the physical means of holding the outer tube of the concentric tubing set stationary while cycling the inner tube up-and-down. Actuator kits are available for manually or mechanically powering the MB470 pump.

For the manual actuator shown in Figure 2.2, the outer tube of the concentric tubing set is attached to the probe rods using two adapters. The inner tubing is raised and lowered by hand to obtain the groundwater sample. Refer to Section 4.4 for more actuator options.

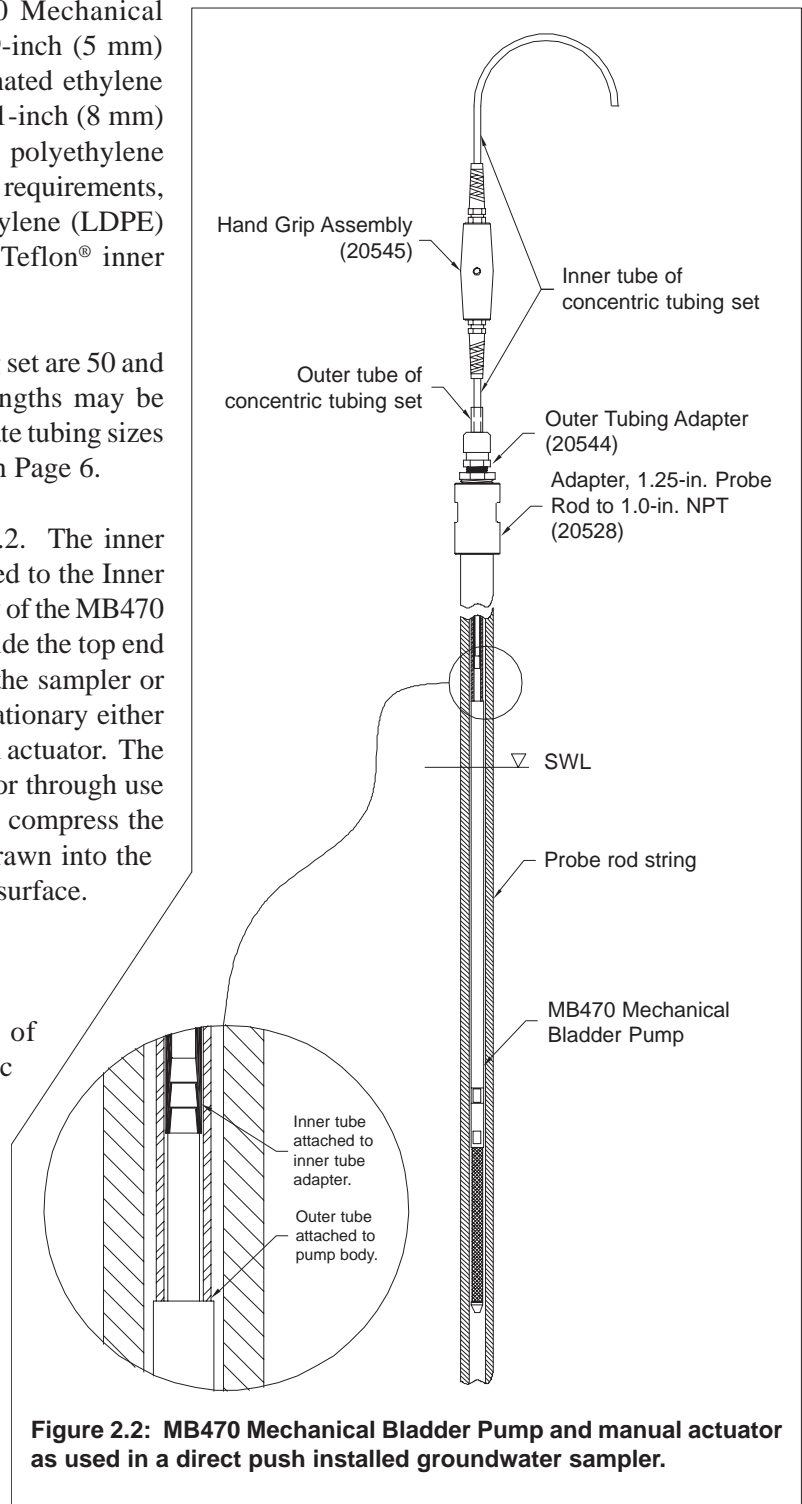

Figure 2.2: MB470 Mechanical Bladder Pump and manual actuator as used in a direct push installed groundwater sampler.

3.0 REQUIRED EQUIPMENT

The following equipment is required to collect representative groundwater samples using the Model MB470 Mechanical Bladder Pump. Refer to Figure 3.1 for identification of the specified parts.

<u>Pump Components</u>	<u>Quantity</u>	<u>Part Number</u>
Mechanical Bladder Pump	-1-	MB470
Service Parts Kit, for MB470 Pump	-1-	MB7500
Includes: O-ring Pick	-1-	AT102
Corrugated Bladder, Teflon® FEP	-3-	21804
Compression Spring, Stainless Steel (SS)	-1-	21805
O-rings for Lower Bladder Adapter (#5-585 Fluorosilicone), Pkg. of 10	-1-	22258
O-rings for Inner Tube Adapter (#010 Fluorosilicone), Pkg. of 10	-1-	22272
Check Balls (7/32-in. diameter), SS, Pkg. of 10	-1-	22259
MBP Assembly Tool	-1-	20456
MBP Cleaning Brush Kit	-1-	MB7300
MBP Assembly Tool	-1-	20456

<u>Tubing Options</u>	<u>Quantity</u>	<u>Part Number</u>
Concentric Tubing Set, HDPE (outer)/FEP (inner), .44-in. OD x 50-ft. length	Variable	MB5050
Concentric Tubing Set, HDPE/FEP, .44-in. OD - 100-ft. length	Variable	MB5100
Concentric Tubing Set, HDPE/LDPE, .44-in. OD - 50-ft. length	Variable	MB5051
Concentric Tubing Set, HDPE/LDPE, .44-in. OD - 100-ft. length	Variable	MB5101
Concentric Tubing Set, HDPE/PP, .44-in. OD - 50-ft. length	Variable	MB5052
Concentric Tubing Set, HDPE/PP, .44-in. OD - 100-ft. length	Variable	MB5102
LDPE Tubing, .19-in. ID x .25-in. OD - 100-ft. length	Variable	TB171L
LDPE Tubing, .19-in. ID x .25-in. OD - 500-ft. length	Variable	TB17L
Teflon® FEP Tubing, .19-in. ID x .25-in. OD - 50-ft. length	Variable	TB17T
Teflon® FEP Tubing, .19-in. ID x .25-in. OD - 100-ft. length	Variable	TB171T
Teflon® FEP Tubing, .19-in. ID x .25-in. OD - 500-ft. length	Variable	TB175T
PP Tubing, .17-in. ID x .25-in. OD - 50-ft. length	Variable	TB17P
PP Tubing, .17-in. ID x .25-in. OD - 100-ft. length	Variable	TB171P
HDPE Tubing, .31-in. ID x .44-in. OD - 50-ft. length	Variable	TB31H
HDPE Tubing, .31-in. ID x .44-in. OD - 100-ft. length	Variable	TB311H
HDPE Tubing, .31-in. ID x .44-in. OD - 500-ft. length	Variable	TB315H

<u>Actuator Options</u>	<u>Quantity</u>	<u>Part Number</u>
Manual Actuator Kit	-1-	MB7000
Includes: Hand Grip Assembly	-1-	20545
Outer Tubing Grip	-1-	22758
Outer Tubing Adapter	-1-	20544
Mechanical Actuator Assembly	-1-	MB6000
Electric Actuator Assembly, 12VDC	-1-	MB6120
Electric Actuator Kit, 12VDC	-1-	MB6120K
Well Mount Kit (for use with MB6000)	-1-	MB7200

<u>Adapters for Use with Actuators</u>	<u>Quantity</u>	<u>Part Number</u>
MBP PVC Riser Adapter Kit	-1-	MB7100
Includes: PVC Extension, 1.0-in. NPT Pin x 1.0-in. NPT Pin - 12-in. Length	-1-	17560
PVC Coupling, 1.0-in. NPT Box x 1.0-in. NPT Box	-1-	21145
Adapter, 2.0-in. PVC to 1.0-in. NPT Pin	-1-	22759
O-rings for 2.0-in. PVC to 1.0-in. NPT Pin Adapter, pkg. of 25	-1-	22313
Adapter, 1.0-in. PVC to 1.0-in. NPT Pin	-1-	17558
O-rings for 1.0-in. PVC to 1.0-in. NPT Pin Adapter, pkg. of 25	-1-	13942
Adapter, 0.75-in. PVC to 17558 Adapter (0.75-in. PVC requires 2 adapters)	-1-	19424
O-rings for 0.75-in. PVC to 17558 Adapter, pkg. of 25	-1-	13196
Adapter, 0.5-in. PVC to 17558 Adapter (0.5-in. PVC requires 2 adapters)	-1-	17559
O-rings for 0.5-in. PVC to 17558 Adapter, pkg. of 25	-1-	GW1555R
Adapter, Geoprobe® 1.0-in. Probe Rod Pin to 1.0-in. NPT Pin	-1-	20527
Adapter, Geoprobe® 1.25-in. Probe Rod Pin to 1.0-in. NPT Pin	-1-	20528
Adapter, Geoprobe® 1.5-in. Probe Rod Pin to 1.0-in. NPT Pin	-1-	20529

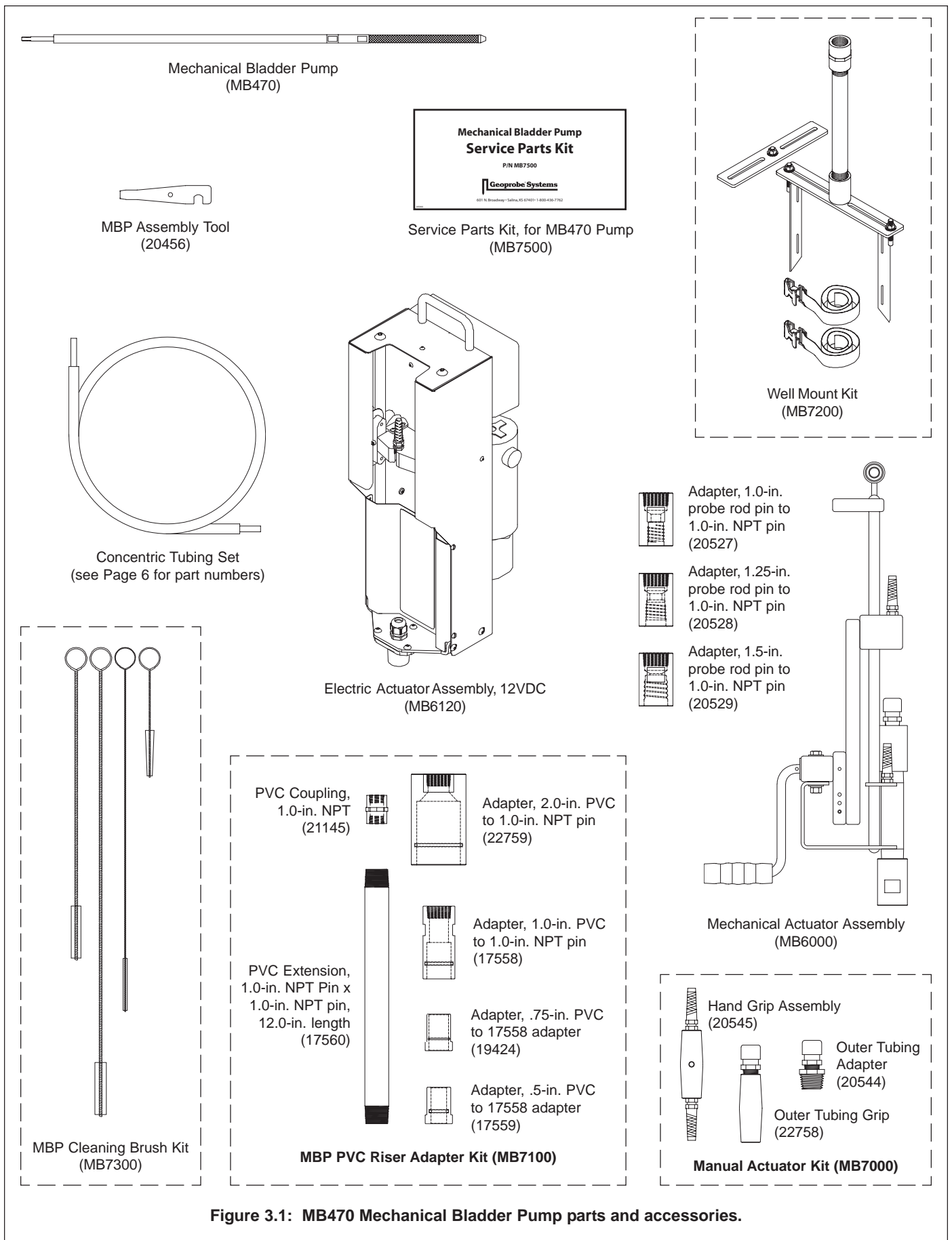

Figure 3.1: MB470 Mechanical Bladder Pump parts and accessories.

4.0 OPERATION

Use and operation of the MB470 Mechanical Bladder Pump may be divided into five main steps:

- *Assembling the Pump*
- *Selecting and installing the concentric tubing set*
- *Selecting and installing the actuator*
- *Purging and sampling*
- *Decontaminating the Pump*

4.1 Assembling the Pump

This section identifies the procedures for assembling the components of the MB470 Mechanical Bladder Pump and performing a leak check on the corrugated bladder. Refer to Figure 4.1 for parts identification.

1. Ensure that all metal parts are clean and free of burrs that may damage the pump threads or the corrugated bladder during assembly.
2. Install two fluorosilicone O-rings (22258) on the Lower Bladder Adapter (20677). Note that these are the larger of the two sizes of O-rings used with the MB470 pump.
3. Lubricate the O-ring of the lower bladder adapter and inside the Bullet Nose Intake (20675) with DI water. Place a Check Ball (22259) in the bullet nose intake and thread the intake onto the lower bladder adapter.

NOTE: The bullet nose intake is used here to make it easier to leak check the pump later in this procedure. After the leak check has been performed, the bullet nose intake may be replaced with a Screen Inlet Assembly (20725) if desired.

4. Install a fluorosilicone O-ring (22272) on the lower end of the Inner Tube Adapter (21573). Note that this is the smaller of the two sizes of O-rings used with the MB470 pump.
5. Lubricate the O-ring of the inner tube adapter and inside the Upper Bladder Adapter (20679) with DI water. Thread the upper bladder adapter onto the inner tube adapter.

NOTE: A check ball must be installed in the upper bladder adapter after performing the leak check in Step 7.

6. Install the Teflon® FEP Corrugated Bladder (21804):
 - The bladder should be installed with the corrugations pointing “up” (toward the upper bladder adapter/ inner tube adapter) as indicated in Figure 4.2.
 - Firmly push and rotate the lower cuff of the bladder over the barbed end of the lower bladder adapter.
 - Firmly push and rotate the upper cuff of the bladder over the barbed end of the upper bladder adapter.
 - Both ends of the bladder should be fully seated on the adapter barbs.

CAUTION: Although firmness is required during installation of the bladder, avoid crushing, kinking, or twisting the bladder corrugations to prevent damage.

7. Perform a leak check on the corrugated bladder before fully assembling the pump components to ensure that the bladder is free of defects. (Leak check procedure is given on opposite page.)

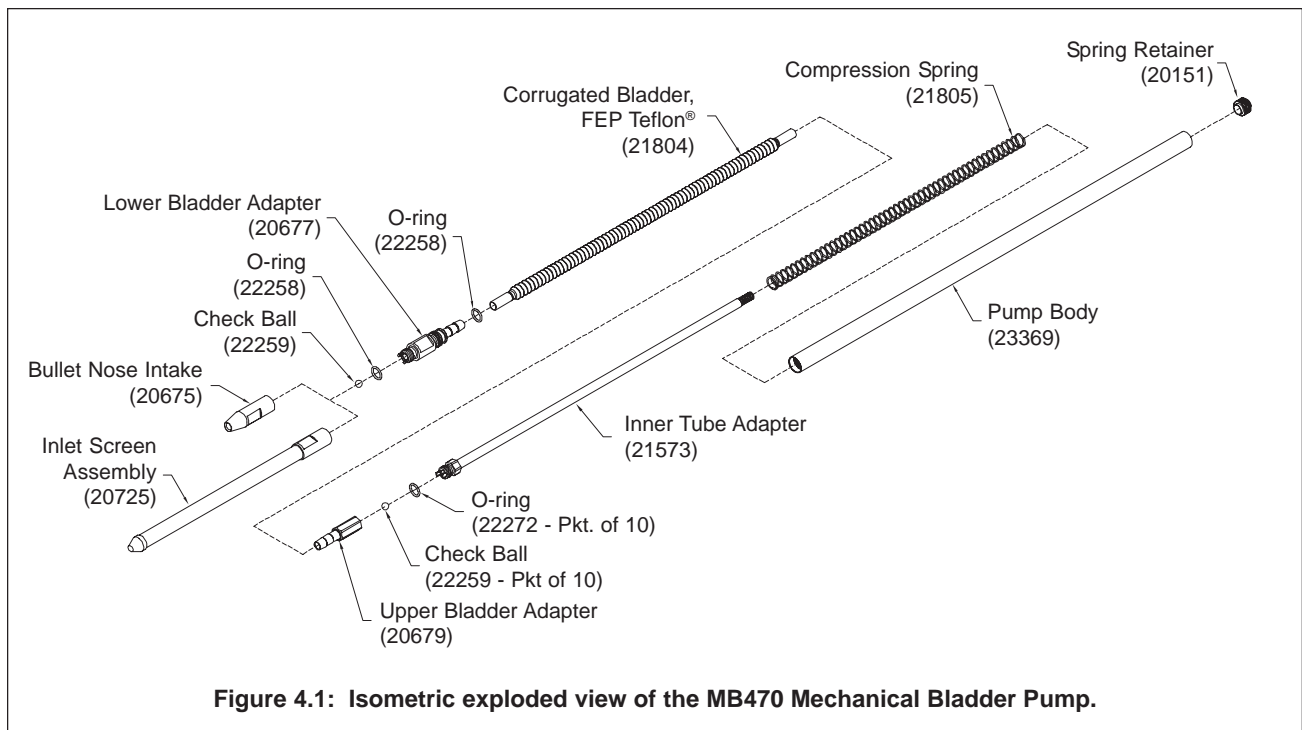

Leak check the corrugated bladder as follows:

- Completely submerge the bladder and lower end of the inner tube adapter in a clean beaker or small bucket of distilled or DI water.
 - Firmly blow into the open end of the inner tube adapter. Leaks in the bladder or assembled parts will be indicated by bubbles.
 - If leaks are found, replace the faulty O-ring(s) or bladder. Retest to ensure that all leakage has stopped.
 - Once the pump has passed the leak test, unthread the upper bladder adapter from the inner tube adapter. Place a Check Ball (22259) in the upper bladder adapter and reinstall it in the inner tube adapter.
 - Replace the bullet nose intake with an Inlet Screen Assembly (20725) if desired. Remember to include the check ball when installing the inlet screen.
8. The Pump Body (23369) is internally threaded at each end. Threads run all the way to the end of the pump body at the upper end, but stop .25 inches (6 mm) from the end at the lower end of the pump body to permit an O-ring seal.

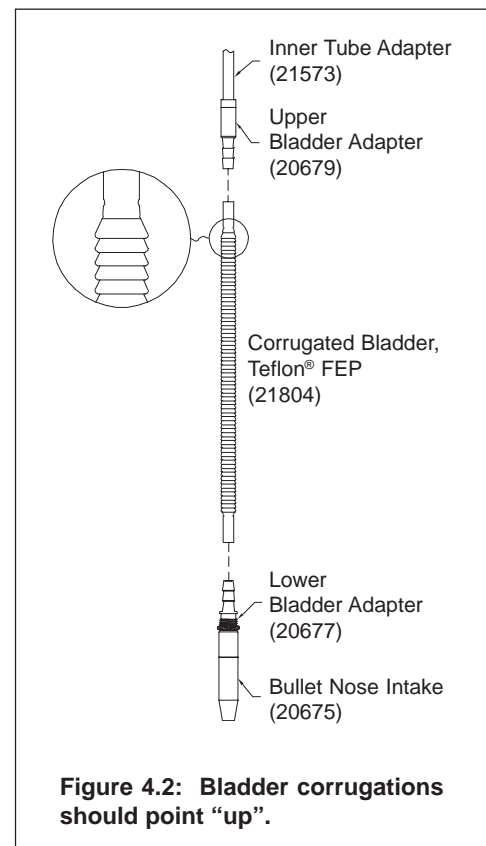

Thread the Spring Retainer (20151) into the top of the pump body. Install the retainer with the slotted end out to allow use of a medium slotted screw driver or the MBP Assembly Tool (20456) to thread or unthread the retainer.

9. Place the Compression Spring (21805) over the top of the inner tube adapter. Slide the spring completely onto the adapter until it contacts the hex fitting.

10. Slide the lower end of the pump body over the top of the inner tube adapter and pump spring. The inner tube adapter will slip through the spring retainer and extend approximately 3 inches (75 mm) from the top of the pump body.
11. The lower bladder adapter is now threaded into the pump body to complete the assembly process.
 - Lubricate the O-ring on the lower bladder adapter and inside the lower end of the pump body with DI water.
 - Grasp the pump body with one hand and the lower bladder adapter with the other hand.
 - Gently compress the spring and bladder into the pump body.
 - Thread the lower bladder adapter into the pump body. Use care to avoid cutting or pinching the O-ring while threading the parts together. The O-ring will no longer be visible when the adapter is fully seated.

Assembly of the MB470 Mechanical Bladder Pump is now complete.

4.2 Selecting and Installing the Concentric Tubing Set

Selecting the Concentric Tubing Material and Length

The outer tube of the concentric tubing set commonly consists of .44-inch OD x .31-inch ID (11.2 mm x 7.9 mm) HDPE material. Inner tube material options are Teflon® FEP, LDPE, or PP. Teflon® FEP and LDPE tubing have dimensions of .25-inch OD x .19-inch ID (6.4 mm x 4.8 mm) while the PP tubing measures .25-inch OD x .17-inch ID (6.4 mm x 4.3 mm).

LDPE inner tubes are the least expensive option. The elasticity of this material may be excessive for deeper wells and in warm ambient conditions (summertime). Teflon® FEP inner tubes are less elastic and provide higher sample quality compared to LDPE due to the chemical properties of the two materials. Teflon® FEP also has a lower coefficient of friction for smoother actuation of the bladder and less resistance to operation, especially at greater depths. The main drawback of Teflon® FEP is its higher cost. PP inner tubes provide a compromise between LDPE and Teflon® FEP in that they are less elastic and provide higher sample quality than LDPE at a lower cost than Teflon® FEP.

While Teflon® FEP exhibits relatively good chemical inertness, it will absorb and desorb some volatile organic contaminants (Parker & Ranney 1998). Because of this, ambient groundwater should be purged through the pump and tubing system for a period of time to achieve equilibrium between the bladder and tubing and sample fluid. The period of time may vary for different volatile organic compounds (VOCs), but if low flow sampling (Puls and Barcelona 1996, ASTM 2003) is conducted, chemical equilibrium may be achieved by the time the monitored water quality parameters (DO, ORP, turbidity, etc.) have stabilized.

Preassembled concentric tubing sets are available from Geoprobe Systems® in lengths of 50 and 100 feet (15.2 and 30.5 m). The user may choose to assemble sets of custom lengths from separate rolls of inner and outer tubing in preparation for the sampling event or while on-site. Be careful to keep the tubing clean while inserting the inner tube into the outer tube.

When long tubing sets are required, it may be wise to use clean PVC riser pipe to protect the tubing during assembly. Simply thread PVC riser sections together, placing them on the shop floor or along the ground surface. Cap one end of the casing to keep dirt and debris out during assembly. Determine the length of the outer tube required and make the PVC casing about the same length. Slide the outer tube into the PVC casing and cut to the desired length. Slide the inner tube into the outer tube. Cut the inner tube three or more feet longer than the outer tube to complete the concentric tubing set.

Keep all tubing stored in clean airtight bags or containers so that dirt, dust, and cross contamination are not a concern or problem. No matter how clean the pump is, sample quality will suffer if the tubing is dirty. Be sure the tubing is of clean, quality material and is not marked with inks that may contribute to cross contamination.

Installing the Concentric Tubing Set on the MB470 Pump

The concentric tubing set is attached to the mechanical bladder pump by pushing the inner tube onto the hose barb on the end of the inner tube adapter and then threading the outer tube into the pump body.

1. Push the inner tube of the concentric tubing set onto the hose barb on the end of the inner tube adapter (Fig. 4.3). Fully seat the tube on the adapter such that the tube engages all three barbs. Take care not to kink or otherwise damage the tubing.
2. Before installing the outer tube, unthread the lower bladder adapter from the pump body and lay the partially disassembled pump on a clean, level surface. This step is recommended so that the bladder is not twisted or damaged as the outer tubing is installed.

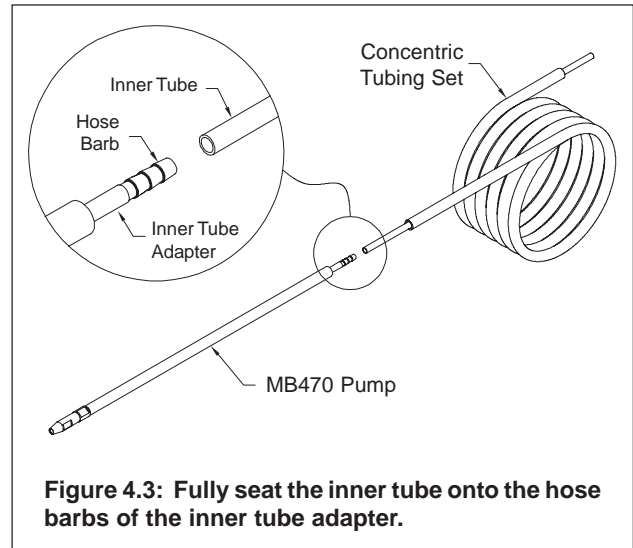

Figure 4.3: Fully seat the inner tube onto the hose barbs of the inner tube adapter.

3. Push and thread the outer tube into the top end of the pump body (Fig. 4.4). The outer tube should be threaded about 0.75 inches (19 mm) into the pump body until it butts against the spring retainer. Remember to take care not to kink or otherwise damage the tubing during installation.
4. Rotate the lower bladder adapter counterclockwise one or two revolutions to minimize torque on the bladder when threading the adapter into the pump body. Now reinstall the lower bladder adapter and inner tube adapter into the lower end of the pump body.

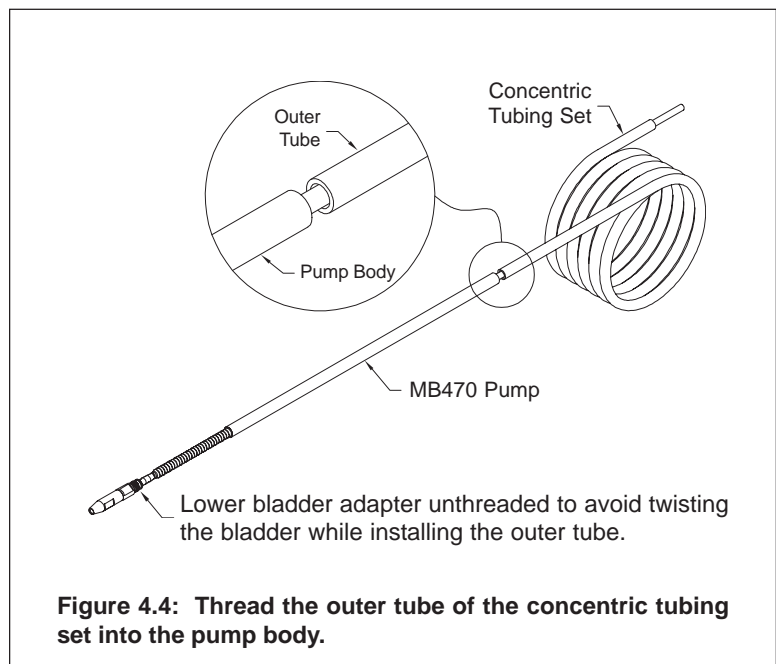

Figure 4.4: Thread the outer tube of the concentric tubing set into the pump body.

The pump and tubing set are now assembled and ready for installation into the monitoring well or sampler.

NOTE: Friction between the inner and outer tubes may make it difficult to attach the pump with the tubing set coiled. To overcome this problem, attach the pump while the concentric tubing is unrolled in the PVC riser sections as described at the bottom of Page 10.

The user may also choose to lower the concentric tubing set partway down the tool string or well, attach the pump to the exposed end of the tubing, retrieve the tubing set, and install the pump for purging or sampling. If this technique is used, **take great care to avoid dropping the tubing set down the well or tool string during attachment of the pump.**

4.3 Selecting and Installing the Actuator

Operating the mechanical bladder pump requires holding the outer tube of the concentric tubing set stationary while moving the inner tube up-and-down. Although this maneuver is possible by simply holding the outer tube in one hand and moving the inner tube with the other hand, an actuator makes operation of the pump significantly easier.

NOTE: The tubing set must be completely unrolled for the inner tube to slide freely within the outer tube.

This section identifies the available actuator options. Methods by which the actuators attach to the concentric tubing set and are installed on the monitoring well or tool string are also addressed.

Handheld Manual Actuator

The handheld actuator option is the first step above simply grasping the inner and outer tube by hand. With this option, a Hand Grip Assembly (20545) and Outer Tubing Grip (22758) are installed on the concentric tubing set (Fig. 4.5). Sampling or purging is accomplished by physically holding the outer tubing grip in one hand while raising and lowering the hand grip assembly with the other hand. A handheld actuator may be used to purge or collect samples through probe rods from a groundwater sampler as well as from a permanent monitoring well.

Installation of the handheld actuator is described below.

1. Determine the depth to which the pump inlet will be installed as measured from the top probe rod or riser pipe with a weighted tape or water level meter.
2. The distance from the pump inlet to the top of the tool string or riser pipe (from Step 1) may now be marked on the outer tube. Obtain an assembled MB470 Mechanical Bladder Pump (Section 4.1) with a concentric tubing set installed as instructed in Section 4.2. Beginning from the pump inlet, measure the appropriate distance along the outer tube and mark it with electrical tape or a suitable marker. The tubing set will be installed such that this mark is aligned with the top of the probe rods or riser.
3. Leading with the end opposite the compression fitting, slide the outer tubing grip over the top end of the tubing set. It may be necessary to loosen the fitting slightly (Fig. 4.6) to allow installation.
4. Position the grip with the lower end even with, or slightly above the line marked on the outer tube in Step 2. The specific location of the grip should be determined by operator preference. The important thing is that the pump inlet is maintained at the appropriate level during sampling as indicated by the mark on the outer tube.

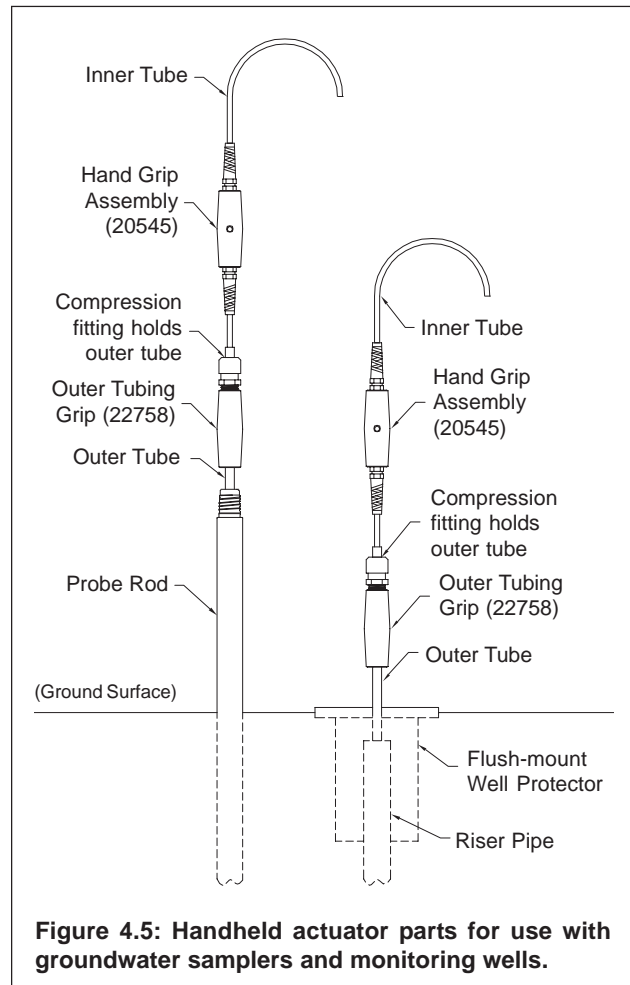

Figure 4.5: Handheld actuator parts for use with groundwater samplers and monitoring wells.

5. Secure the grip to the outer tube by tightening the large nut of the compression fitting (Fig. 4.6) until it is “hand tight”. Do not overtighten as this may damage the plastic fitting.
6. Carefully cut off the excess outer tube leaving approximately .25 inches (6 mm) above the compression fitting. (Note that the inner tube is not cut at this location). Now measure and cut the inner tube leaving it approximately 3 feet (1 m) longer than the outer tube.
7. Slide the hand grip assembly over the inner tube and position it 1-2 inches (25-51 mm) above the outer tubing grip as shown in Figure 4.6. It may be necessary to first loosen the two compression fittings to allow installation over the inner tube.
8. Secure the hand grip by tightening the two compression fittings. Take care not to overtighten and damage the fittings. Also avoid kinking the inner tube while completing this step

To operate the mechanical bladder pump with the handheld actuator, simply insert the pump into the probe rod string or monitoring well. Lower the pump and concentric tubing set until the mark on the outer tube (measured and marked previously in Step 2, Page 12) is aligned with the top of the probe rod string or well riser. Initiate pump flow by holding the outer tubing grip stationary with one hand while cycling the hand grip assembly up-and-down with the other hand. A pump stroke of up to approximately 6 inches (150 mm) is recommended.

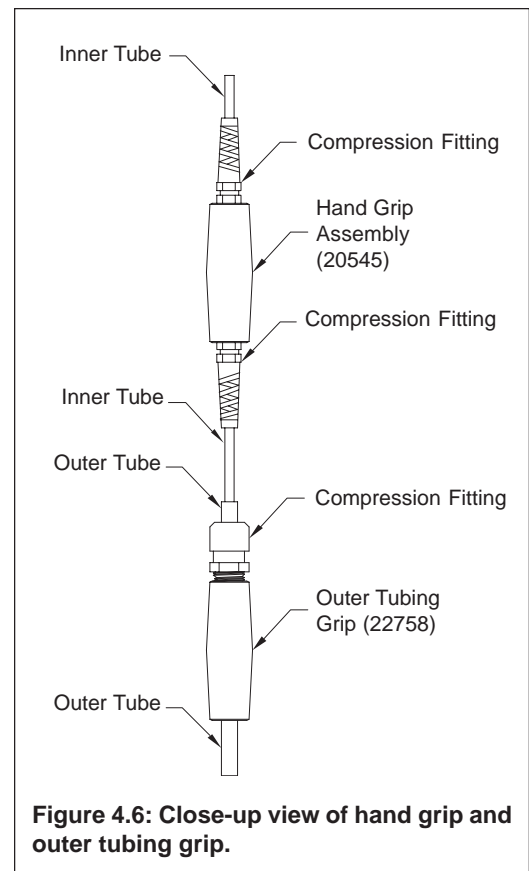

Figure 4.6: Close-up view of hand grip and outer tubing grip.

Anchored Manual Actuator

The anchored actuator option is similar to the handheld actuator in that the mechanical bladder pump is cycled by physically raising and lowering the inner tube using the Hand Grip Assembly (20545). But while the handheld actuator requires a second hand to hold the outer tube, the anchored actuator option utilizes adapters to mechanically secure the outer tubing to the top probe rod or riser pipe as shown in Figure 4.7.

Installation of the mechanical bladder pump with the anchored actuator option is reviewed in this section for both probe rod and well riser applications.

1. The outer tube of the concentric tubing set is connected to the top probe rod or well riser using an Outer Tubing Adapter (20544) plus additional adapters as determined by the size of rod or riser onto which the actuator is to be installed.

Referring to Table 4.1, select the appropriate adapter(s) for your size of probe rod or well riser. Illustrations and complete descriptions of the various adapters are presented in Table 4.2 and Figures 4.8 - 4.10. Note that .5-inch and 0.75-inch riser pipe each require two PVC adapters in addition to the outer tubing adapter.

2. Assemble the adapters by threading the outer tubing adapter into the probe rod or well riser adapter.

As illustrated in Figure 4.8, two adapters are required to attach the outer tubing adapter to .5-inch and .75-inch riser pipe. After threading the outer tubing adapter into the 1.0-inch PVC to 1.0-inch NPT Adapter (17558), either a .5-inch PVC adapter (19424) or .75-inch PVC adapter (17559) is then installed in the remaining end of the 1.0-inch PVC adapter.

3. Determine the depth to which the pump inlet will be installed as measured from the top probe rod or riser pipe with a weighted tape or water level meter.

4. The distance from the pump inlet to the top of the tool string or riser pipe (from Step 3) is now marked on the outer tube:

Obtain an assembled MB470 Mechanical Bladder Pump (Section 4.1) with a concentric tubing set installed as instructed in Section 4.2. Beginning from the pump inlet, measure the appropriate distance along the outer tube and mark it with electrical tape or a suitable marker. The tubing set will be installed such that this mark is aligned with the top of the probe rods or riser.

5. Slide the assembled adapters (from Step 2) over the top end of the tubing set leading with the end opposite the compression fitting. See Figure 4.7 for adapter orientation. It may be necessary to loosen the compression fitting slightly to allow installation.

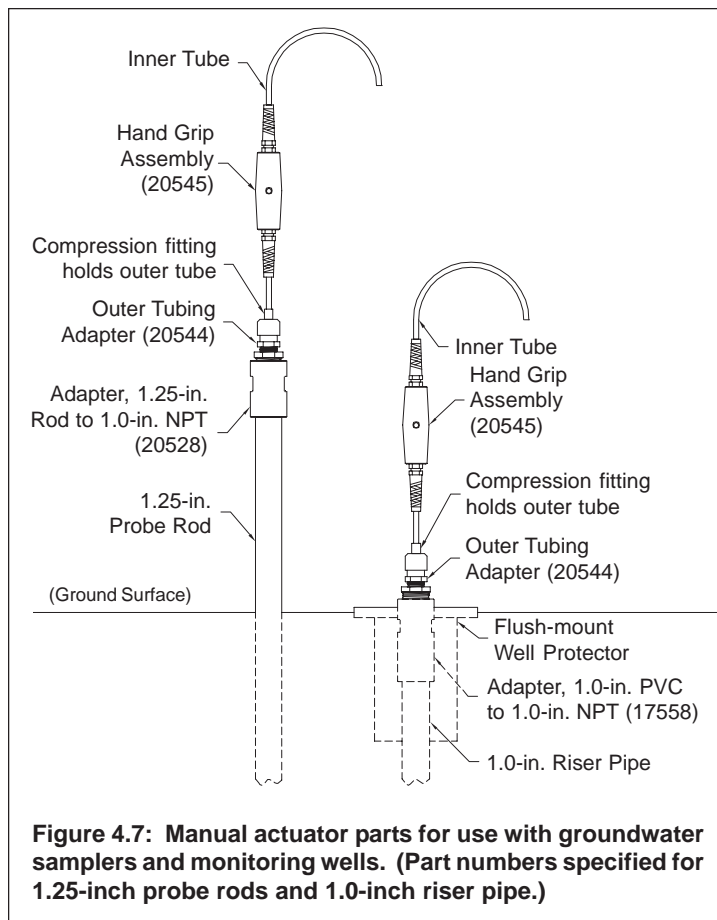

Figure 4.7: Manual actuator parts for use with groundwater samplers and monitoring wells. (Part numbers specified for 1.25-inch probe rods and 1.0-inch riser pipe.)

6. Position the adapters such that the line marked on the outer tube in Step 4 will be even with the top of the probe rod or well riser when the pump is installed on the tool string or riser.

7. Secure the adapters to the outer tube by tightening the large nut of the compression fitting (Fig. 4.7) until it is “hand tight”. Do not overtighten as this may damage the plastic fitting.

Size	Probe Rod Adapters	Monitoring Well Riser Adapters
.5-inch	na	17559, 17558, and 20544
.75-inch	na	19424, 17558, and 20544
1.0-inch	20527 and 20544	17558 and 20544
1.25-inch	20528 and 20544	na
1.5-inch	20529 and 20544	na
2.0-inch	na	22759 and 20544

Table 4.1: Part numbers for the adapters required to attach the outer tube to various probe rods and PVC riser pipe.

8. Carefully cut off the excess outer tube leaving approximately .25 inches (6 mm) above the compression fitting. (Note that the inner tube is not cut at this location). Now measure and cut the inner tube leaving it approximately 3 feet (1 m) longer than the outer tube.

9. Slide the hand grip assembly over the inner tube and position it 1-2 inches (25-51 mm) above the outer tubing grip as shown previously in Figure 4.6. It may be necessary to first loosen the two compression fittings to allow installation over the inner tube.

10. Secure the hand grip by tightening the two compression fittings until they are hand tight. Do not overtighten the plastic fittings as damage may result.

Illustration	Part Number	Description
	20544	Outer Tubing Adapter
	20527	Adapter, 1.0-in. probe rod pin to 1.0-in. NPT pin
	20528	Adapter, 1.25-in. probe rod pin to 1.0-in. NPT pin
	20529	Adapter, 1.5-in. probe rod pin to 1.0-in. NPT pin
	22759	Adapter, 2.0-in. PVC to 1.0-in. NPT Pin
	17558	Adapter, 1.0-in. PVC to 1.0-in. NPT Pin
	19424	Adapter, .75-in. PVC to 17558 Adapter
	17559	Adapter, .5-in. PVC to 17558 Adapter

Table 4.2: Adapters for attaching the outer tube to probe rods and PVC riser pipe.

- Lower the mechanical bladder pump down the probe rods or well riser. Secure the outer tubing adapter by threading it onto the top probe rod or sliding it over the top of the well riser.

The mechanical bladder pump is now ready for purging and/or sampling.

Operation of the mechanical bladder pump with a manual actuator is limited to simply raising and lowering the hand grip assembly using a stroke length up to 6 inches (152 mm). This action extends and retracts the pump bladder to push formation fluid to the ground surface through the inner tube of the concentric tubing set. The outer tube is attached to the probe rod string or well riser by adapters and is thus held stationary while the pump is actuated.

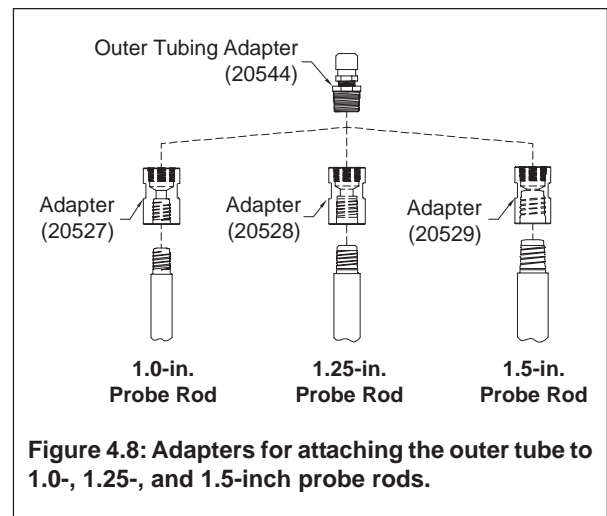

Figure 4.8: Adapters for attaching the outer tube to 1.0-, 1.25-, and 1.5-inch probe rods.

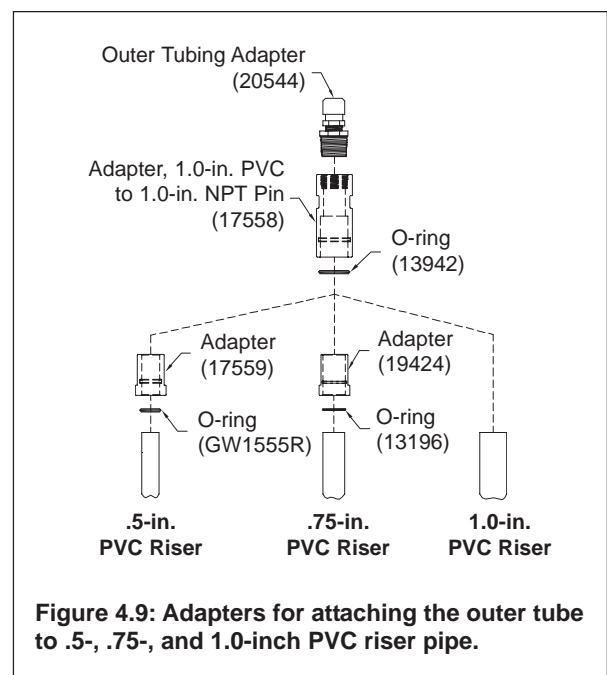

Figure 4.9: Adapters for attaching the outer tube to .5-, .75-, and 1.0-inch PVC riser pipe.

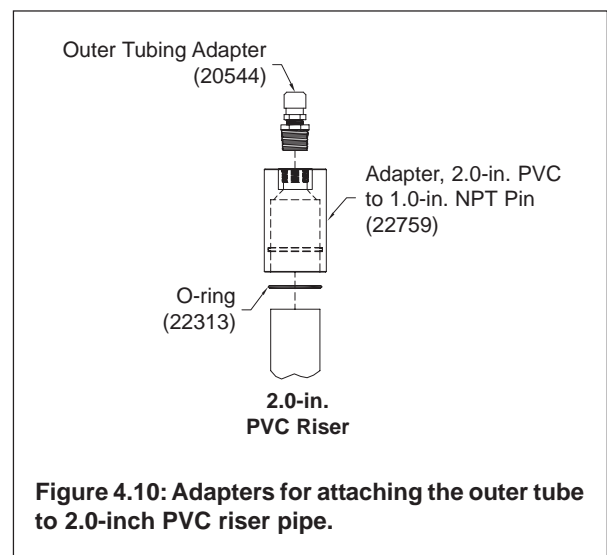

Figure 4.10: Adapters for attaching the outer tube to 2.0-inch PVC riser pipe.

Mechanical Actuator

The third actuator option for the MB470 Mechanical Bladder Pump is a Mechanical Actuator Assembly (MB6000, Figure 4.10). Rather than physically raising and lowering the inner tube to cycle the pump, the operator simply rotates the handle on the side of mechanical actuator. The actuator assembly converts this rotational action to vertical movement of the inner tube which cycles the pump. The operator may also choose to manually raise and lower the inner tube by disconnecting the side handle and utilizing the T-handle at the top of the assembly.

An advantage of the mechanical actuator option is that it requires little physical input to operate the pump. This translates to minimal operator fatigue when purging or sampling from multiple wells during the day.

The mechanical actuator assembly may be installed directly on a probe rod string (Fig. 4.10) or attached to a flush-mount or aboveground well protector using a Well Mount Kit (MB7200) as shown in Figures 4.11 and 4.12. Installation and operation of the mechanical actuator are described below.

1. Determine the depth to which the pump inlet will be installed as measured from the top of the probe rods or well protector with a weighted tape or water level meter.
2. The distance from the pump inlet to the top of the tool string or well protector (from Step 1) may now be marked on the outer tube:

Obtain an assembled MB470 Mechanical Bladder Pump (Section 4.1) with a concentric tubing set installed as instructed in Section 4.2. Beginning from the pump inlet, measure the appropriate distance along the outer tube and mark it with electrical tape or a suitable marker. The tubing set will be installed such that this mark is aligned with the top of the probe rods or well protector.

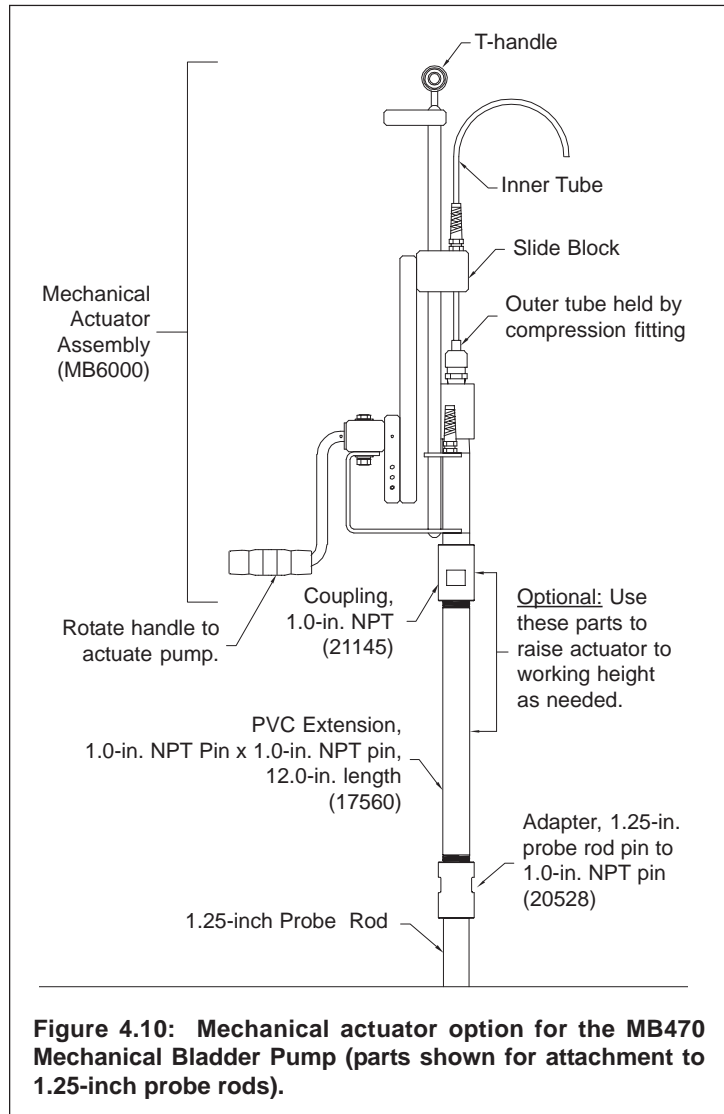

3. **For monitoring wells only:** Install a Well Mount Kit (MB7200, Figure 3.1) on the well protector. The well mount is strapped onto aboveground well protectors as shown in Figure 4.11 and bolted onto flush-mount well protectors as shown in Figure 4.12. Note that the cross adapter is used for flush-mount protectors that utilize three bolts on the cover (Fig. 4.12) or when the well riser is significantly off center in the protector.
4. Lower the pump and concentric tubing set down the probe rod string or through the well mount into the riser pipe. Stop when the mark on the outer tube (from Step 2) is near the top of the probe rods or well protector.
5. **For probe rods only:** Referring to Table 4.2, select the appropriate Probe Rod Pin to 1.0-inch NPT Pin Adapter (20527, 20528, or 20529) to attach the actuator to the top probe rod. Thread this adapter (and a 12-inch extension if additional height is needed) into the actuator as shown on the completed assembly in Figure 4.10.

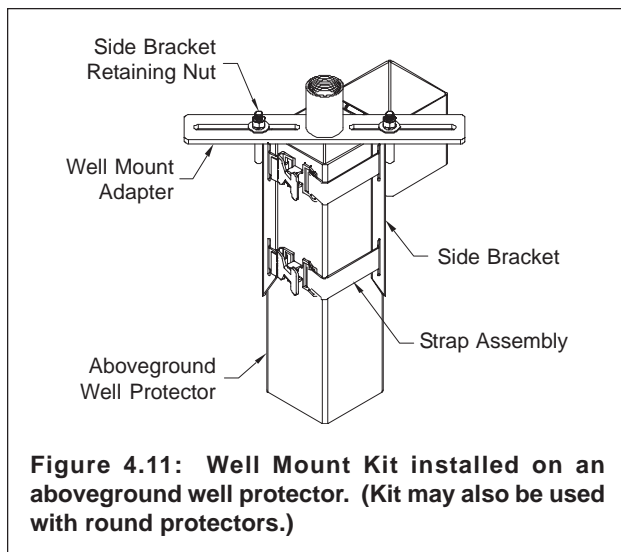

6. Insert the top end of the concentric tubing set through the lower end of the mechanical actuator assembly. Feed the tubing set through the actuator and out the compression fitting identified in Figure 4.10.

For probe rods only: The mark on the outer tube (Step 2) will not be visible once the actuator is installed on the probe rods. To allow for this, position the tubing within the actuator such that the mark will be at the top of the rods when the actuator is installed. Now mark the outer tube at the compression fitting of the actuator assembly for reference later in the installation procedure.

7. Thread the mechanical actuator onto the top probe rod or well mount until all connections are hand tight.
8. Verify the position of the outer tube by observing the mark placed on the tube in Step 2 or 6. Tighten the compression fitting (hand tight) to secure the tubing. Do not overtighten as this may damage the fitting.
9. Carefully cut off the excess outer tube leaving approximately .25 inches (6 mm) above the compression fitting. (Note that the inner tube is not cut at this location).
10. Taking care not to kink the inner tube, insert the inner tube up through the compression fitting on the actuator slide block (see Fig. 4.10 for identification of slide block). It may help to raise the slide block during this step.

With the slide block fully lowered, gently pull up on the inner tube to remove slack. Do not pull so far that the pump spring is compressed. Tighten the compression fitting to secure the inner tube. Again, do not overtighten as this may damage the plastic fitting.

11. Cut the inner tube leaving it approximately 3 feet (1 m) longer than the outer tube. You may choose to insert the end of the inner tube through the top of the compression fitting on the side of the actuator. This will limit movement of the tube outlet while operating the pump

The mechanical bladder pump is ready for operation by rotating the side handle of the mechanical actuator or disconnecting the side handle linkage and manually raising and lowering the T-handle.

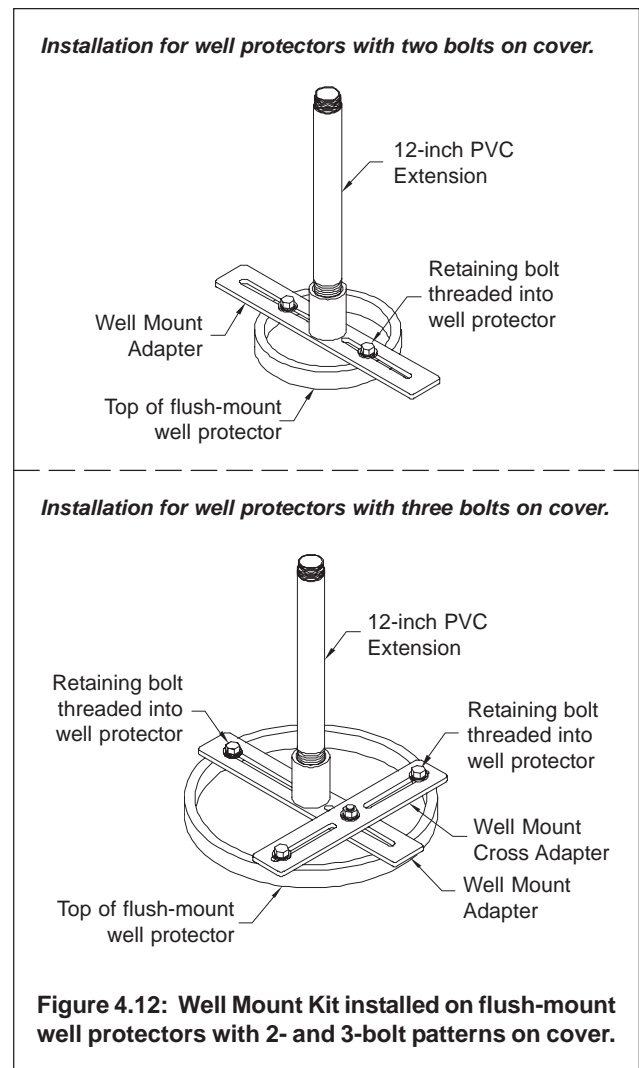

4.4 Purging and Sampling

The MB470 Mechanical Bladder pump was designed to provide an economical and efficient method to conduct the low flow sampling protocol (Puls and Barcelona 1996, ASTM 2003), Nielsen and Nielsen 2002). The basis of this protocol is that a sampling flow rate of 500 ml/min or less for 2-inch wells (100 to 200 ml/min for smaller diameter direct push wells) generally provides a sample of higher quality that is more representative than sampling at high flow rates (e.g. several liters or gallons per minute). Higher quality samples for volatile organic compounds are obtained because the water being sampled is subjected to less physical and chemical stress so that loss of these analytes does not occur. Additionally, higher quality samples for inorganic analytes (e.g. lead, hexavalent chromium, etc.) are obtained because the low flow sampling method minimizes turbidity that can cause significant bias for these sensitive analytes.

To obtain the most representative samples, the monitoring well or temporary groundwater sampler should be developed before sampling is conducted. Development may consist of simple surging and purging with an inertial pump for temporary samplers depending on the data quality objectives (Geoprobe® 2002). However, more elaborate methods may be required for some monitoring wells (ASTM 2001).

To meet the full requirements of the low flow sampling protocol, field parameters of the pre-sample purge water (temperature, pH, specific conductance, ORP, DO, and turbidity) should be monitored using an in-line flow cell. Once these parameters have stabilized, the samples are then collected in clean, preserved sample containers appropriate for the analytes of concern. Pre-sample purging may be completed in as little as 10 to 20 minutes in adequately developed small-diameter wells with as little as 5 to 10 liters of water generated. In larger diameter wells that have not been adequately developed, a significantly longer purge time and volume may be required.

4.5 Decontaminating the Pump

Decontamination of the pump may be performed in two general ways. For the highest integrity samples the pump should be fully disassembled for thorough decontamination (decon) and the bladder and O-rings replaced. If the pump is being used as a portable pump for sampling multiple locations daily, the pump may be decontaminated while assembled. Review and understand the sampling and data quality objectives for your project before selecting the appropriate decontamination procedure. (For further information on data quality objectives see EPA 1997, or Geoprobe® 2002). The concentric tubing set should be replaced between each sampling location to minimize the potential for cross contamination. If possible, sample from background or low concentration wells to higher concentration wells to minimize the chance for cross contamination.

Disassemble for Decontamination

Simply reverse the procedures described in Section 4.1 to disassemble the pump and concentric tubing set. Place the disassembled pump in a clean beaker or small bucket of water. Use distilled water for highest level of decon. Add Alconox soap (or similar cleaning agent) to the water. Thoroughly clean and brush all inside and outside surfaces. The MBP Cleaning Brush Kit (MB7300) includes four small-diameter brushes selected specifically to clean inside the various pump components. Double rinse all parts with distilled or deionized (DI) water and allow to air dry. Reassemble the pump using a new bladder and O-rings.

Review ASTM Practice D5088 for further guidance and detail on decon procedures. Additional decontamination may be obtained by drying the disassembled pump in a clean drying oven at about 95°C (203°F). This will provide additional assurance that volatile contaminants are removed from pump surfaces.

Decontamination of Assembled Pump

While this method will not provide the assurance of the highest quality samples it may be preferred when lower sample quality is acceptable (For further information on data quality objectives see EPA 1997, or Geoprobe® 2002). When initial site assessments are conducted it is often desirable to obtain many samples at a reasonably modest cost so as to adequately characterize a site. This decon procedure will help reduce the per sample cost while providing acceptable sample quality for many site assessments.

Remove the concentric tubing set from the pump and discard. Submerge the pump in clean soapy water and pump several volumes of water through the pump. Thoroughly wash the exterior of the pump removing all visible dirt or stains. Rinse and transfer the pump to a container of clean tap water or deionized water. Again pump multiple volumes of water through the pump and wash the pump exterior to remove all soap. A second rinse is recommended. Allow the pump to air dry. Again, drying the fully assembled pump in a clean drying oven at about 95°C (203°F) will further remove any volatiles from pump surfaces.

Rinsate Samples

Regularly collect rinsate samples from the pump following decontamination and submit the samples for analysis for the analytes of concern. This will provide another level of quality control and assurance that samples meet the site-specific data quality objectives. Pump clean distilled water through the pump and collect the fluid in an appropriate preserved container. Store, ship and handle rinsate samples in the same manner as field samples.

5.0 REFERENCES

- American Society of Testing and Materials (ASTM), 2003. D6771-02 Standard Practice for Low-Flow Purging and Sampling for Wells and Devices Used for Ground-Water Quality Investigations. ASTM, West Conshocken, PA. (www.astm.org)
- American Society of Testing and Materials (ASTM), 2001. D-5521 Standard Guide for Development of Ground-Water Monitoring Wells in Granular Aquifers. ASTM, West Conshocken, PA. (www.astm.org)
- American Society of Testing and Materials (ASTM), 1999. D-5088 Standard Practice for Decontamination of Field Equipment Used at Nonradioactive Waste Sites. ASTM, West Conshocken, PA. (www.astm.org)
- U.S. Environmental Protection Agency (EPA), 2003. Environmental Technology Verification Report: Geoprobe Inc., Mechanical Bladder Pump Model MB470. Office of Research and Development, Washington, D.C. EPA/600R-03/086. August.
- U.S. Environmental Protection Agency (EPA), 1997. Expedited Site Assessment Tools for Underground Storage Tank Sites: A Guide for Regulators. Office of Solid Waste and Emergency Response. EPA 510-B-97-001. March.
- Geoprobe®, 2002. Groundwater Quality and Turbidity vs. Low Flow. Geoprobe Systems®, Salina, KS. May.
- Nielsen, David M., and Gillian L. Nielsen, 2002. Technical Guidance on Low-Flow Purging & Sampling and Minimum-Purge Sampling: Second Edition. The Nielsen Environmental Field School, Galena, OH. April.
- Parker, Louise V. and Thomas A. Renney, 1998. Sampling Trace-Level Organic Solutes with Polymeric Tubing, Part 2. Dynamic Studies. Groundwater Monitoring & Remediation (GWMR) Vol. XVIII No. 1, pages 148-155. Winter.
- Puls, Robert W., and Michael J. Barcelona, 1996. Ground Water Issue: Low-Flow (Minimal Drawdown) Ground Water Sampling Procedures. EPA/540/S-95/504. April.

Equipment and tool specifications, including weights, dimensions, materials, and operating specifications included in this brochure are subject to change without notice. Where specifications are critical to your application, please consult Geoprobe Systems®.



-Corporate Offices-

601 N. Broadway • Salina, KS 67401

1-800-436-7762 • Fax 785-825-2097

www.geoprobe.com