

Regen Puller System

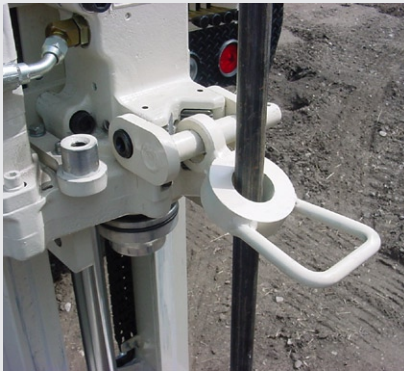

Try this tool once and you'll wonder how you ever got along without it!

- Used for low-load pulling applications with 1.25-inch and 1.5-inch probe rods
- Very forgiving for tool string misalignment
- Ideal for use with Macro-Core® and Dual Tube sampling systems
- Universal design for use with 5400 Series and 6600 Series Geoprobe® machines.
- Optional rod holder base for use with Dual Tube sampling system
- Can't fall off ... bolted directly to the machine hammer



The Regen Puller System ... pulls rods ... pushes rods ... secures rods.

GEOPROBE® REGEN PULLER SYSTEM PARTS

Regen Pull Ring Mounting Rod Assembly	20059
Regen Pull Ring Assembly, for 1.5 in. rods	19917
Regen Pull Ring Assembly, for 1.25-in. rods	19927
Regen Rod Holder Base Assembly	20398
Regen Rod Holder Base	20451

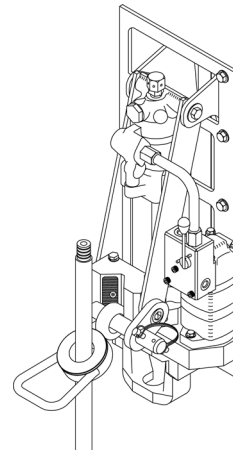

1.

Good Gripper: The Regen Puller System is great for Macro-Core® sampling where rods and tools have a tendency to drop down the probe hole due to multiple tool entries into the same probe hold.

2.

Pushes with no Percussion: The Regen Puller System also pushes rods into the ground when percussion is not required.

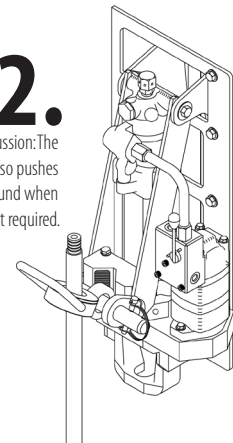

3.

Holds rods too! Regen Puller System used as a rod holder for the DT32 sampling system.

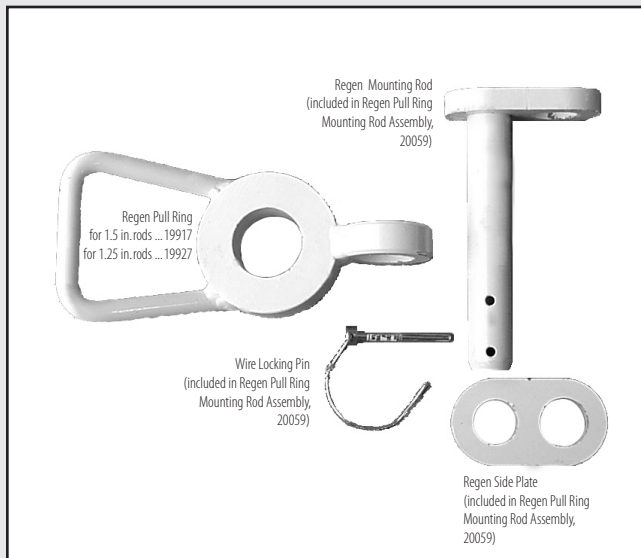
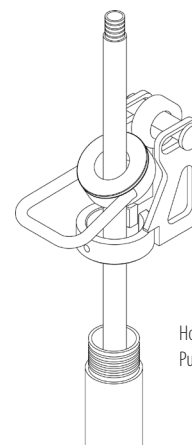

1-800-436-7762 • www.geoprobe.com